

PROPOSED NORDEL WAY IMPROVEMENTS (WEIGH SCALE ROAD TO RIVER ROAD)

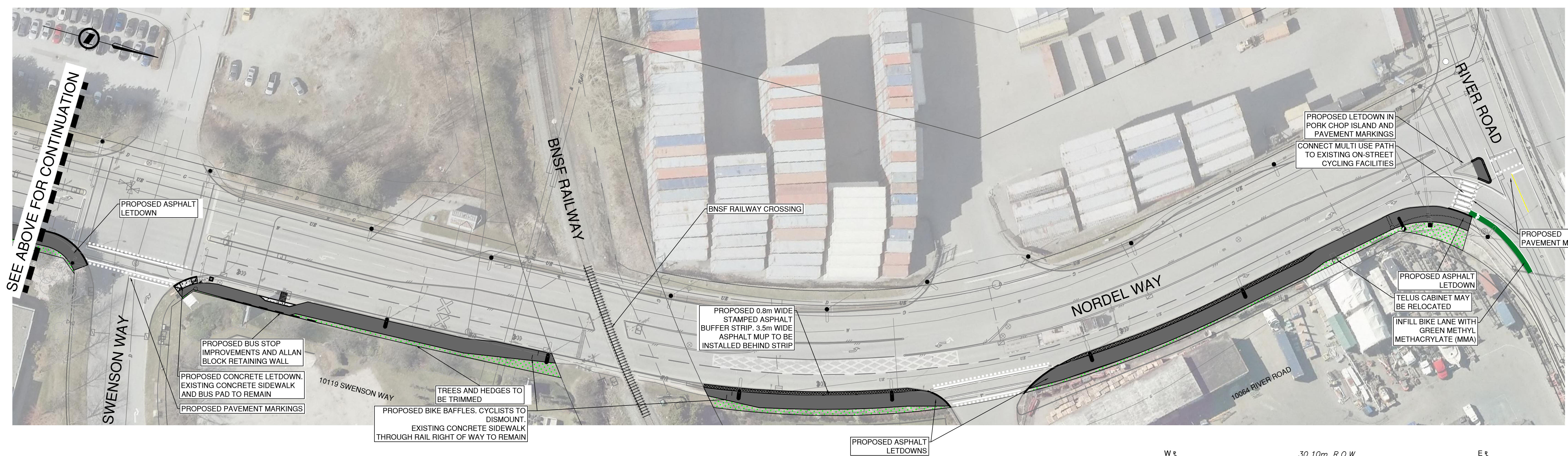

ROADWORKS LEGEND

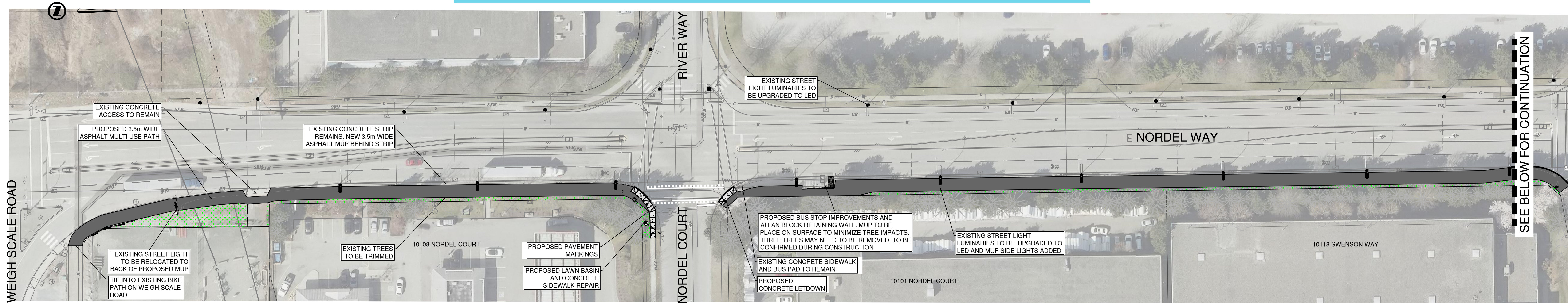
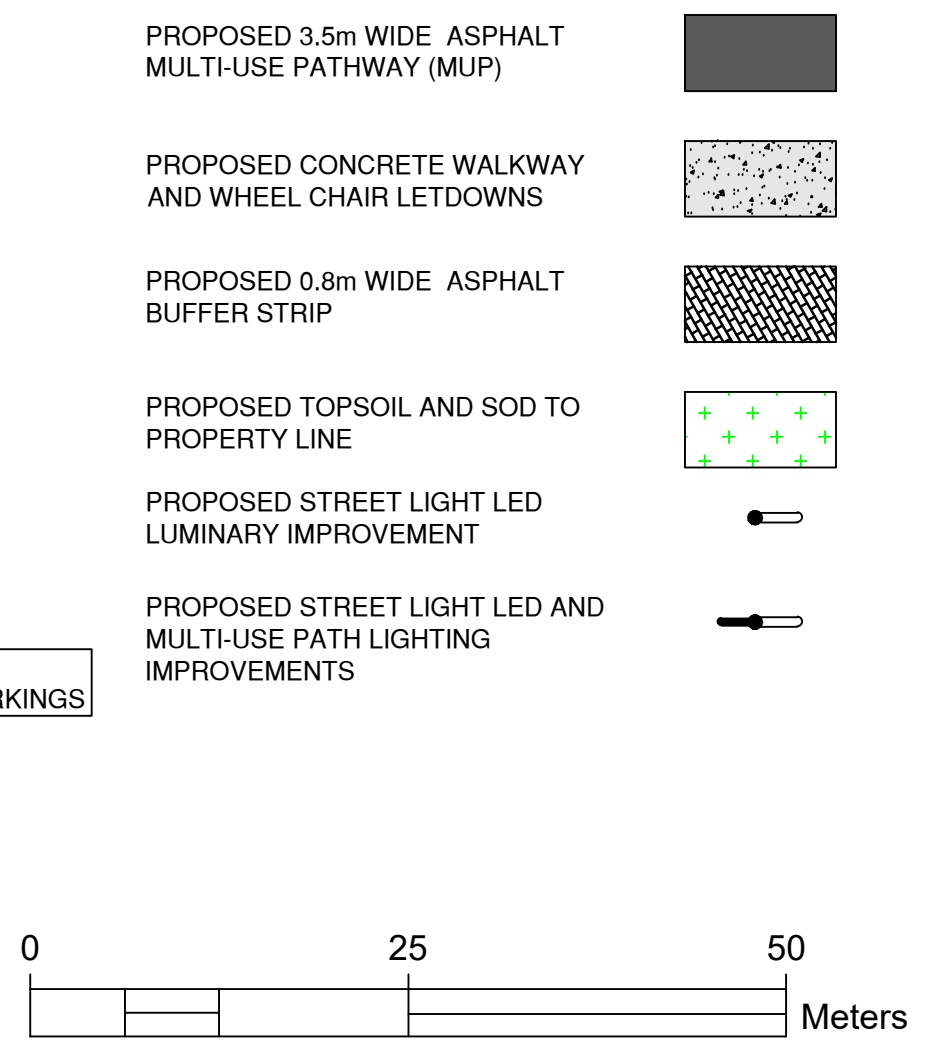

SCOPE OF WORK:

- 3.5m WIDE ASPHALT MULTI-USE PATHWAY WITH 0.8m WIDE ROAD SIDE BUFFER, AND TOPSOIL AND SOD TO PROPERTY LINE
- ROAD AND PATHWAY LED LUMINARY LIGHTING IMPROVEMENTS
- PAVEMENT MARKING AND ON ROAD BIKE ROUTE IMPROVEMENTS
- BUS STOP IMPROVEMENTS INCLUDING WHEELCHAIR ACCESS LANDING PADS AND BUS SHELTER PRE-DUCTING

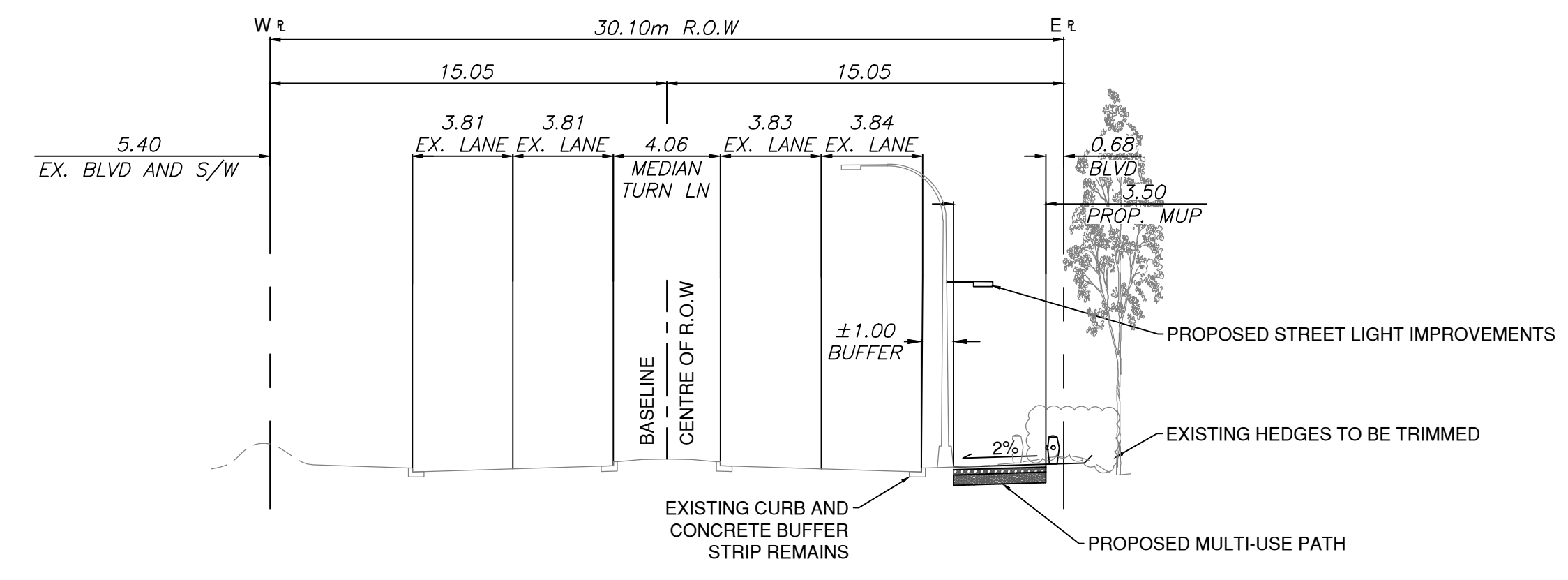

Delta